

EURODRIVE 500 Pull-Engage Override

- 230V 50Hz Single phase motor.
- Adjustable limit switches.
- Integral thermal trip.
- Pull-Engage manual override.
- Tube adaptors from 5"10swg to 6.65".
- 65mm offset (does not require mounting bracket).

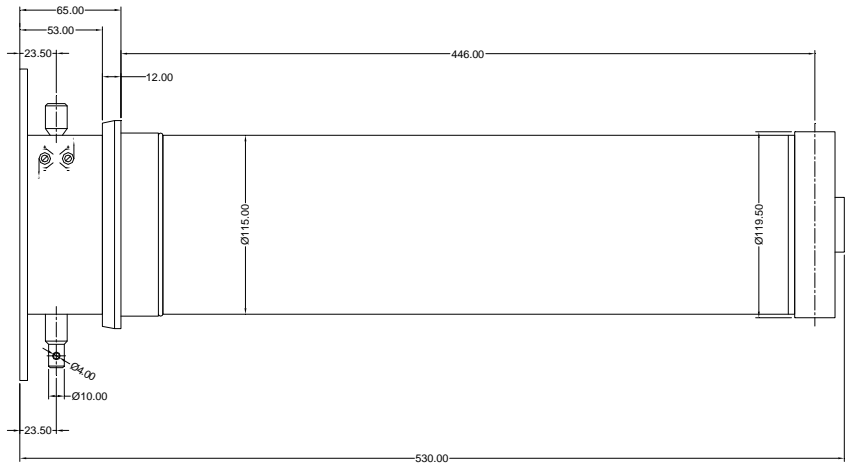

This motor comes complete with one set of adaptors and the following accessory:

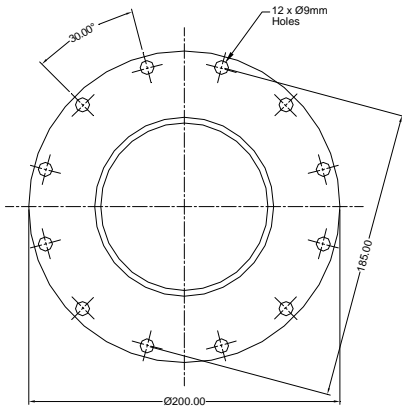

Technical Data	Torque	Power	Current	Voltage	RPM	Lifting Capacity
500 M/O	500 Nm	1350 W	7.2 A	230V 50Hz	7/min	500kg Ø 127mm

Other Link Controls Catalogues Available

Marantec Equipment

Roller Shutter Door Operators

Sectional Door Operators

Sliding / Folding Door Operators

Fire Door Operators

Hazardous Area Equipment

Rapid Roll Door Operators

Gates & Barriers